

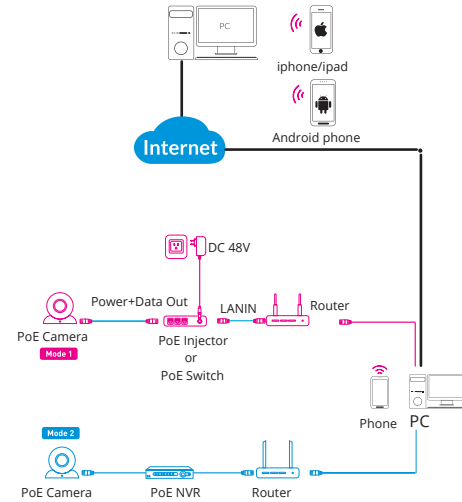

NETWORK CAMERA

Quick Installation Guide

1. Camera Connection Diagram



- Attention:** There are two connection modes:
1. For non-PoE router, please connect the camera by a PoE switch or a PoE injector.
 2. For a POE NVR, please connect the camera directly to the POE NVR, then follow the below steps

2. Installation

Bullet Camera Installation

Ceiling Mounting

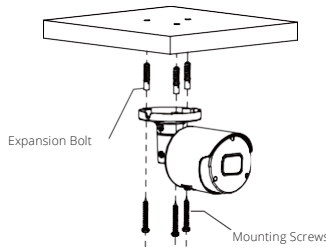

Insert three expansion bolts in place into the ceiling and fix the equipment with three mounting screws.

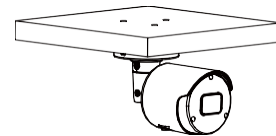

Completion of Installation

Dome Camera Installation

Ceiling Mounting

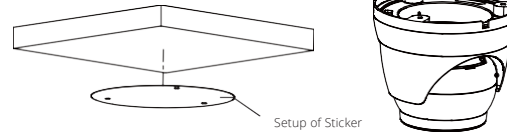

Paste the sticker in place at the proper position as selected.

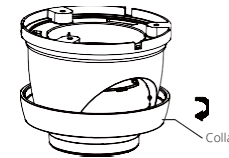

Remove the collar off the camera by rotating it down

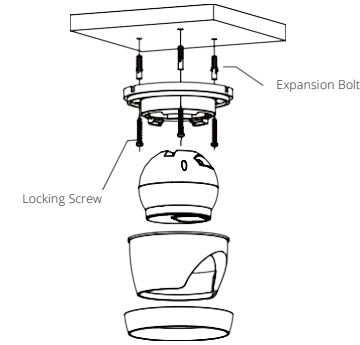

Fix the pedestal by drilling locking holes around the sticker and inserting three expansion bolts into the holes and fastening it with three locking screws.

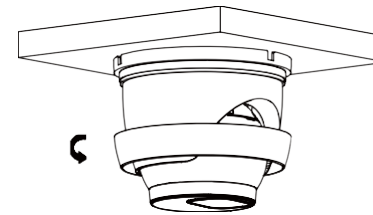

Mount the collar back by rotating it up

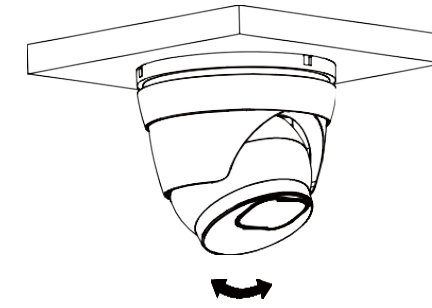

Adjust it to an appropriate angle.

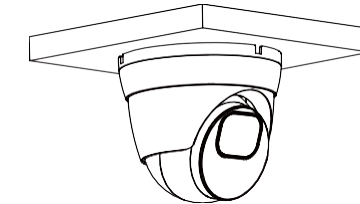

Completion of Installation

Vandal-Proof Dome Camera Installation

Ceiling Mounting

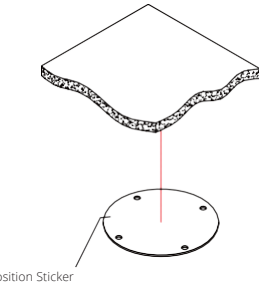

Apply the position sticker to the desired camera mounting position.

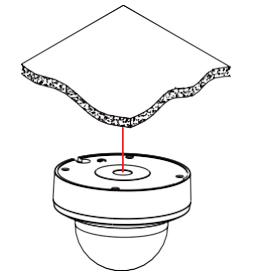

Cover Component

Remove the cover component by loosening the three locking screws with the included hex wrench.

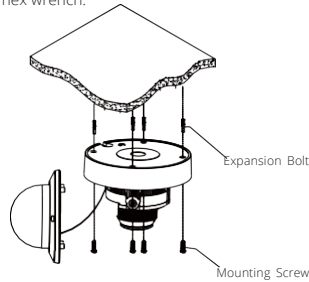

Use the position indicated on the position sticker to drill the holes needed to mount the camera base. Insert the expansion bolt into the holes. Match the base's mount openings to the expansion bolts position, then place the mounting screws through the base's mount opening into the expansion bolt. Tighten the mounting screws to ensure the camera base mounted securely.

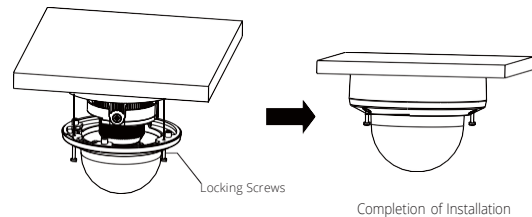

- Place the cover component back onto the base.
- Please make sure the locking screw position on the cover component matches the locking post on the base.
- Tighten the locking screws after the cover component is in the correct position.

3.Install the APP

There are two methods to install the App.

- Search for "Smart Guardian" in the App store or Google play

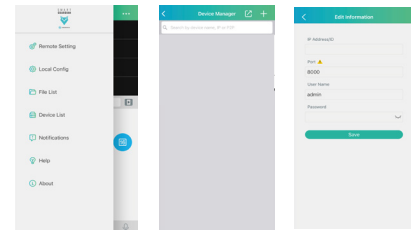

- Scan the QR code below to download the App.



4.Camera Settings

Once you open the "Smart Guardian" app, you will see the following interface to add your device

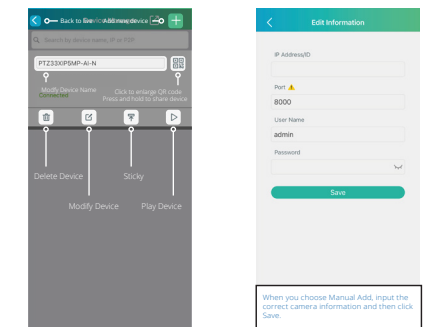
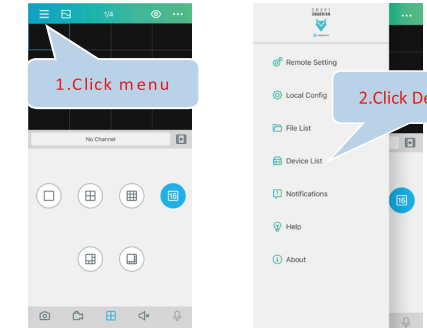

If the device is successfully added, when exiting the device list, you will see the following:

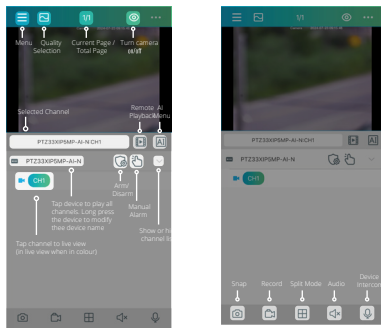

※ Please refer to the "Help" section for more detailed instruction.

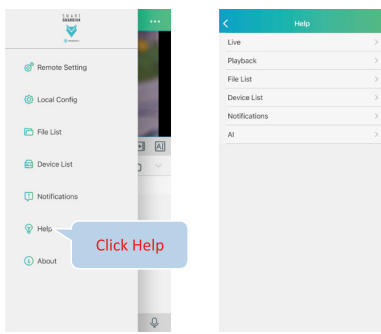

5.In Windows

1. On our website www.gsdgroupinc.com and click "Learning & Support" > "Software" to download "Discovery Tool", it will help to search all the available G.S.D. devices on your local network.

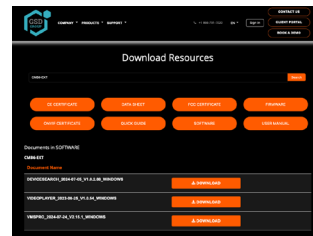

2. In the "Discovery Tool", you can modify the information of a selected device including its IP, Media Port, Web Port, Gateway, Net Mask, etc. (The default username & password is: admin & admin123.)

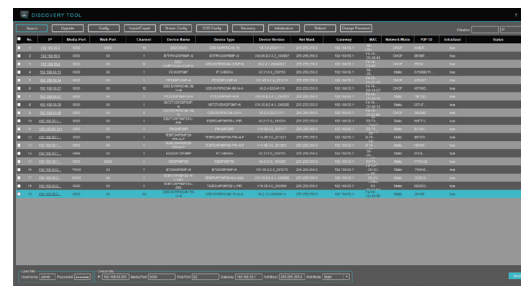

3. Open a web browser and input the device's IP address; Input the username & password in the following interface to login the device.

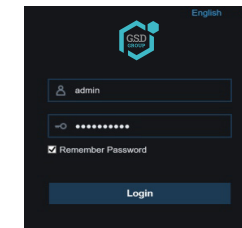

4. After login, click "Remote Setting" to change the settings.

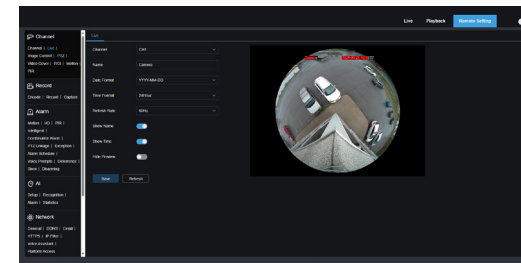

5.In Mac OS

1. Open your router web interface and login.
2. Find the "Attached device" or "Connected device" menu. Find the device's IP address according to its MAC address. The Mac address is labeled on the device.

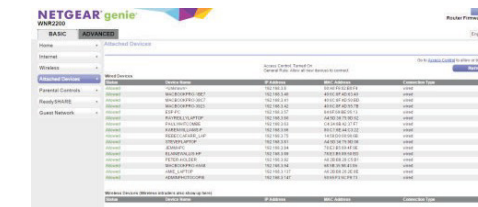

Picture for reference only

3. Input the device's IP address in Safari, login with your username & password.
4. After login, click "Remote Setting" to modify the setting.

For more information, please visit our YouTube channel:



To download our latest firmware and software, please visit gsdgroupinc.com